

Mounting the V1000-4X VFD



Table of Contents

Introduction	2
Parts list.....	2
Determining the VFD model	3
Mounting the 10" VFD.....	4
Mounting the VFD straps.....	5
Mounting the 16" VFD.....	6
Mounting the VFD straps.....	7
Attach the VFD	7
Appendix	8
6" Leg.....	8
12" Leg.....	9

Introduction

We are going to cover the installation of the two major body sizes for the VFD; 10" and 16". The VFDs are specific to different voltages and phases, but this will not impact the external mounting of each unit.

Parts list

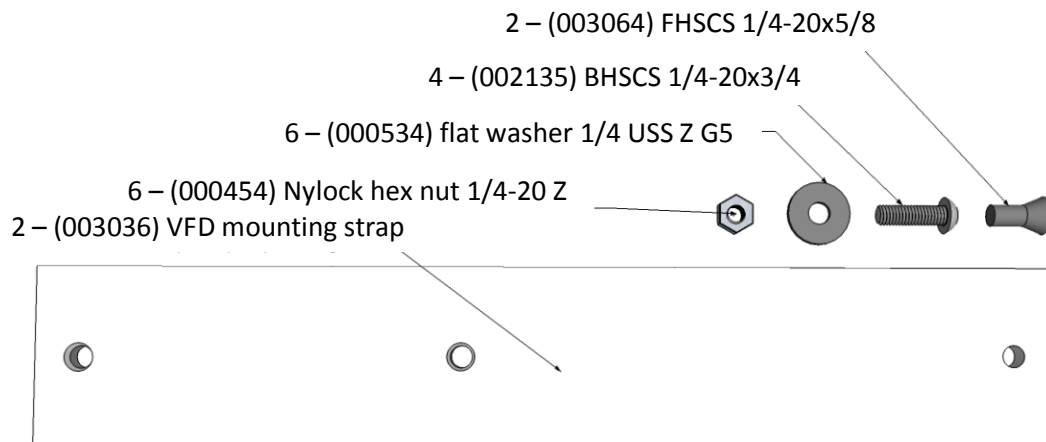

(003065) Kit Mounting VFD 1000

ShopBot Contact Info

ShopBot Tools, Inc.
 3333B Industrial Dr.
 Durham, NC 27704
 919-680-4800 or 888-680-4466
www.shopbottools.com

Determining the VFD model



There are two main types of VFDs, a 10" model and a 16" model. These can be easily differentiated by their size and model numbers. Model numbers are found on the front of the VFD underneath the "RUN" and "STOP" buttons as shown to the left.

There are five different amperage configurations that could've been shipped with your tool. These will not impact installation, but it could be information that tech support needs, so it is included.

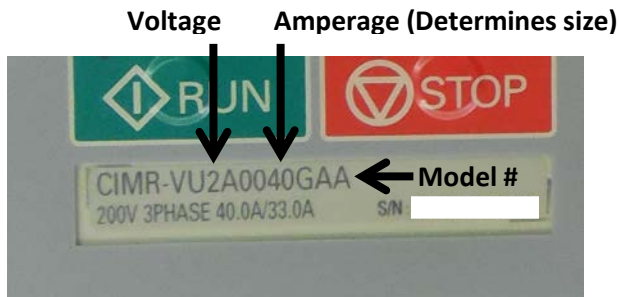

An example model number is shown to the left. The model number is **CIMR-VU2A00**40**GAA**.

The first bold and underlined number in the written example is the voltage.

2 = 200-240 Vac, 3-phase

4 = 380-480 Vac, 3-phase

The model in the example is a 200V model. This information will not change your mounting procedure.

The second bold and underlined number refers to the amperage. This is the part that will determine the sizing of your VFD.

10" VFD Models = 09, 12, and 20

16" VFD models = 30 and 40

In our example, this is a 40A VFD (determined from the 40 in the model number) which is a 16" model. For installing this size model, you would skip to the section titled "Mounting the 16" VFD". The 10" VFD will be covered in the next section.

Mounting the 10" VFD

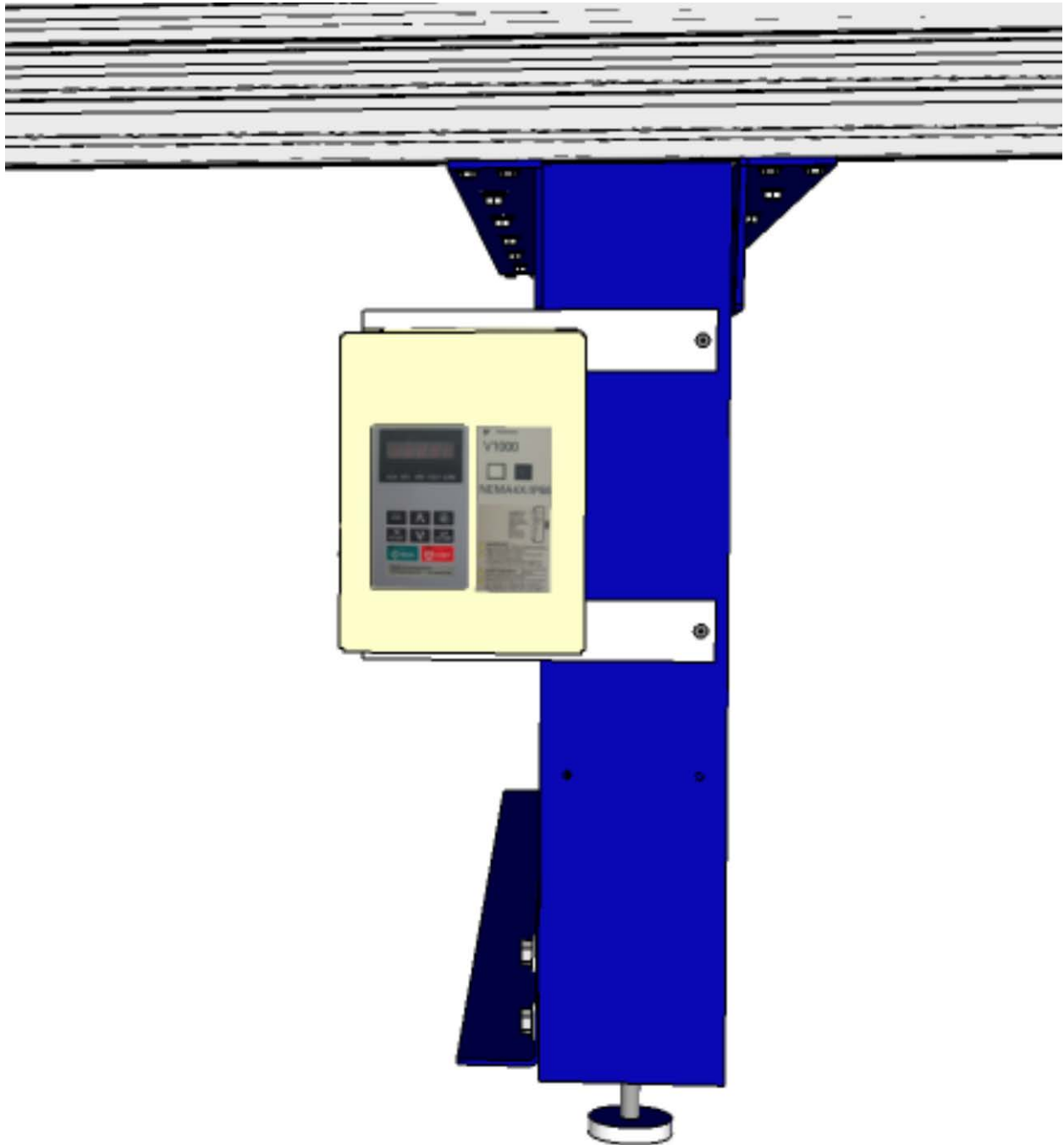

The 10" VFD will mount to the top and middle set of holes in the middle leg of the ShopBot gantry tools with the VFD 1000 mounting kit (003065). If you have an earlier ShopBot that does not have 6 mounting holes on the front middle leg, it may be necessary to check the attached leg drawing in the appendixes and drill the upper and middle set.

Mounting the VFD straps

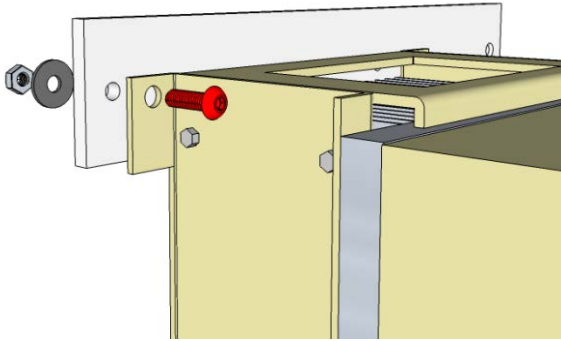

Use the 1/4-20x3/4" button head screw to attach the upper hole of the VFD to the left hole in the strap. Using the 1/4" flat washer and 1/4" nylock nut, securely fasten the VFD to the strap.

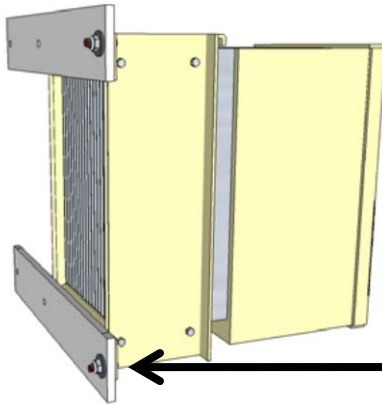

Repeat the above step for the other strap on the bottom of the VFD.

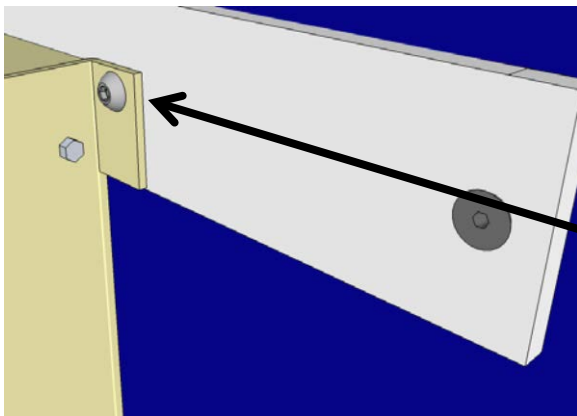

Use the 1/4-20x3/4" button head screw to attach the right upper hole of the VFD to the middle hole in the strap and upper left hole of the leg. Using the 1/4" flat washer and 1/4" nylock nut, securely fasten the VFD and strap to the leg. Repeat this for the lower strap.

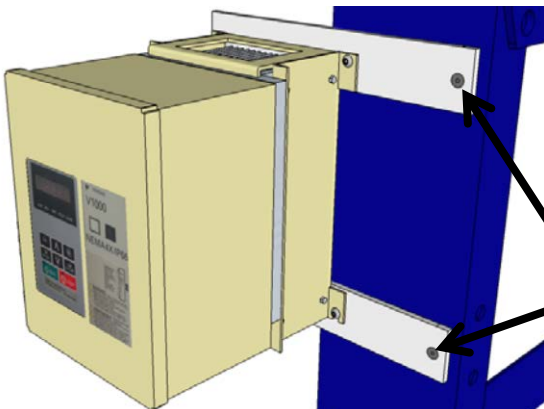

Use the 1/4-20x3/4 flat head screw in the last hole of the strap and fasten it securely to the leg with the 1/4" flat washer and 1/4" nylock nut. Repeat for both straps.

Mounting the 16" VFD

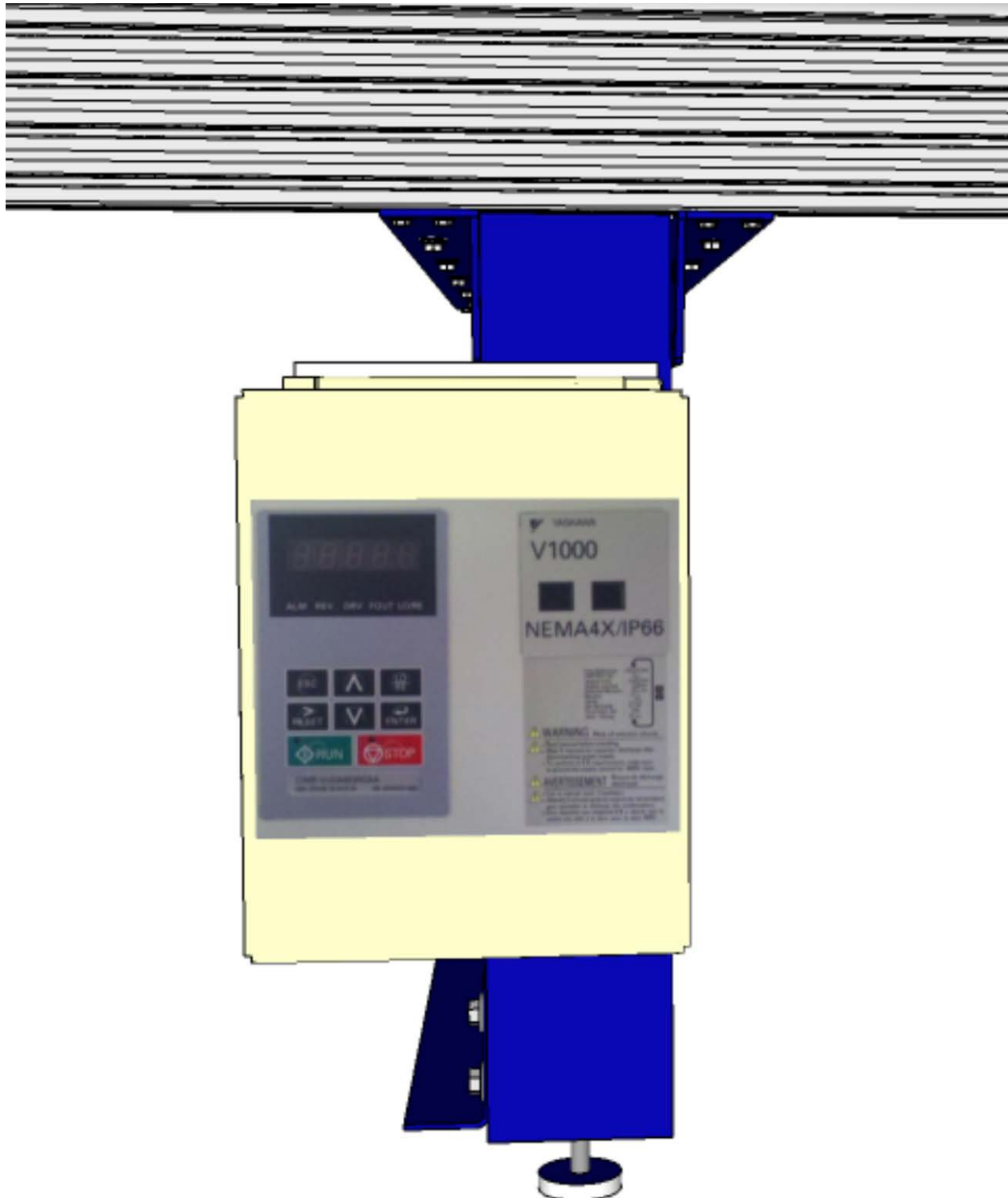

The 16" VFD will mount to the top and bottom set of holes in the middle leg of the ShopBot gantry tools with the VFD 1000 mounting kit (003065). If you have an earlier ShopBot that does not have 6 mounting holes on the front middle, it may be necessary to check the attached leg drawing in the appendixes and drill the upper and lower set.

Mounting the VFD straps

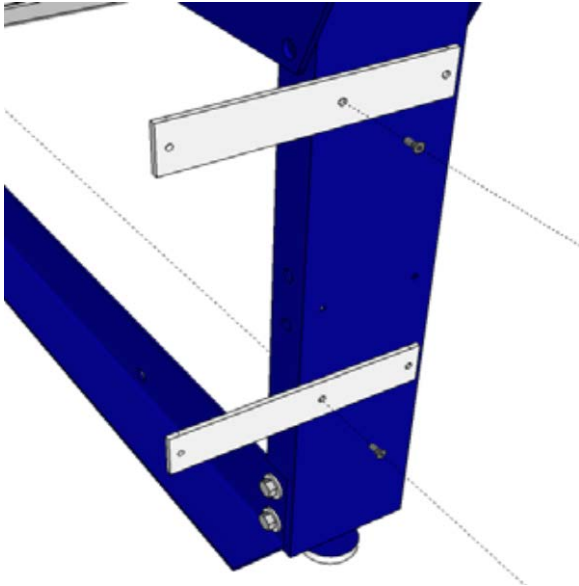

Use the 1/4-20x3/4 flat head screw in the middle hole of the VFD mounting strap and the upper left hole on the front middle leg of the ShopBot. Attach securely using the 1/4" flat washer and 1/4" nylock nut. Repeat this step on the lower set of holes with the second strap.

Attach the VFD

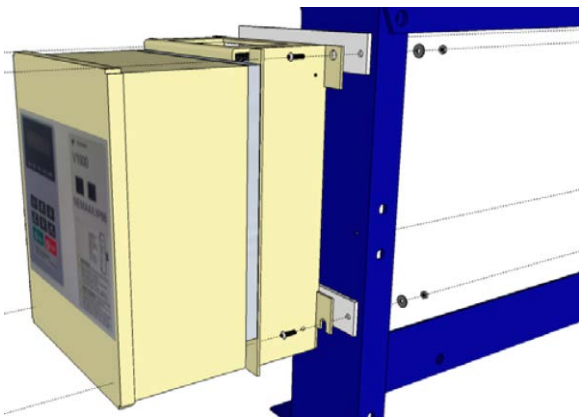

On the right side of the VFD, use the 1/4-20x3/4" button head screw to attach the upper hole of the VFD through the right hole in the strap and into the leg. Using the 1/4" flat washer and 1/4" nylock nut, securely fasten assembly to the leg. Repeat on the lower mounting position.

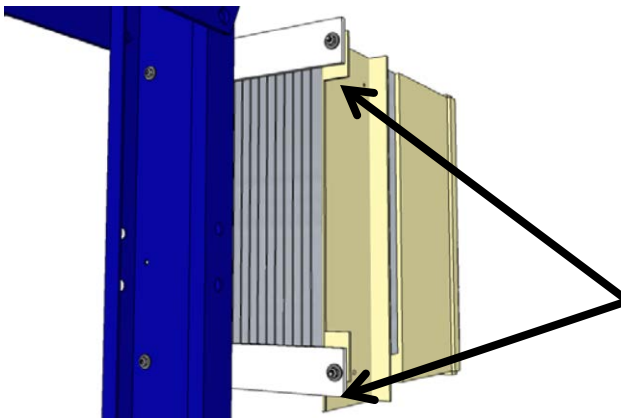

On the left side of the VFD, use the same 1/4-20x3/4" button head screw to attach the upper hole of the VFD to the left hole in the strap. Using the 1/4" flat washer and 1/4" nylock nut, securely fasten to the strap.

Appendix

6" Leg

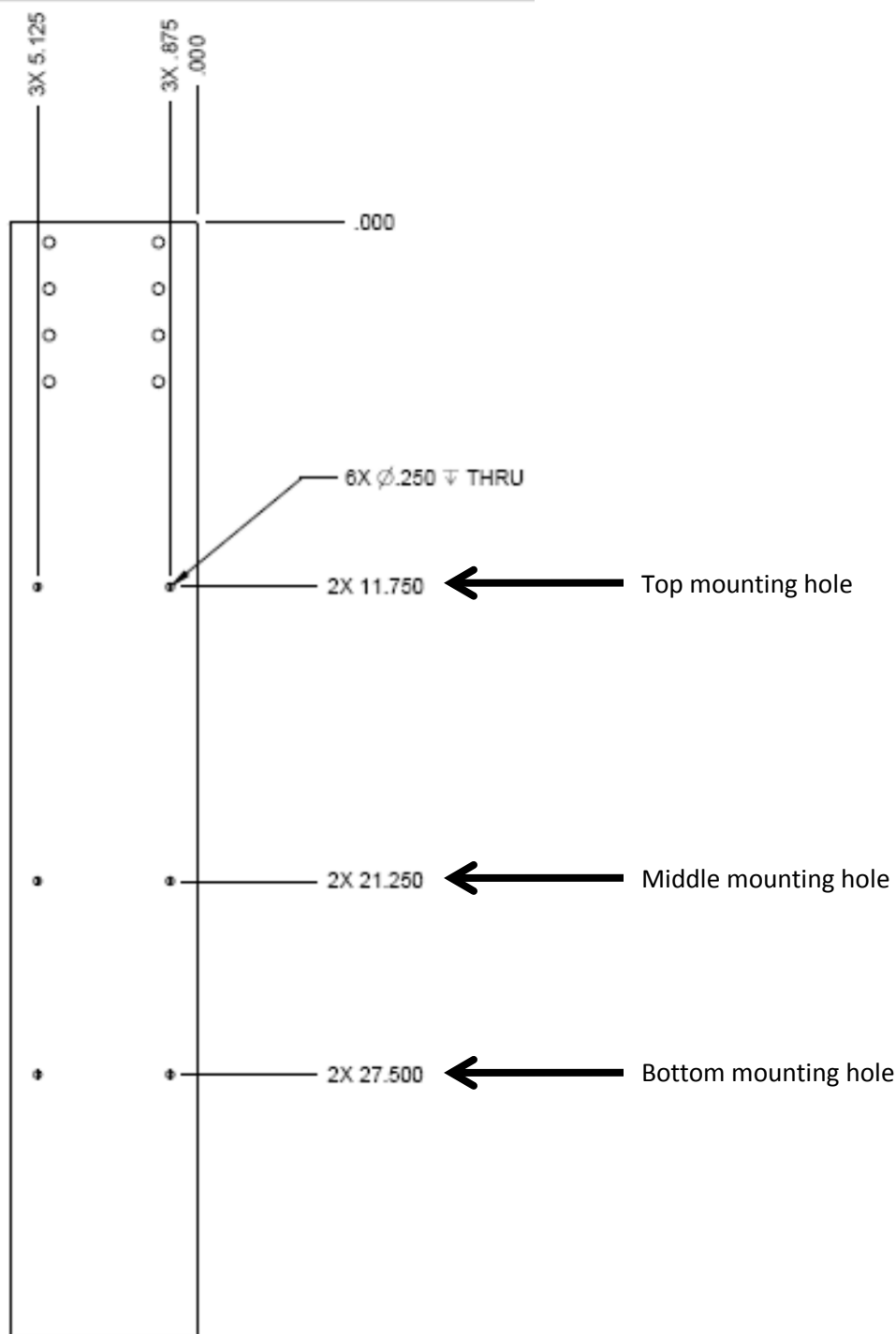

12" Leg

