

# ShopBot®

We make  
the tools  
for making the  
future.

## Project: Jigsaw Puzzles

**Overview:** Cut a panda bear or a duck puzzle to create hours of entertainment for kids of all ages. The files for these jig saw puzzles allow the user to cut both projects at once using two different types of wood. There are also a set of individual files to cut only one at a time.

**Materials:** Red Oak and Walnut

**Minimum Cutting Area:** Each wood species calls for a 16" x 24" area

**Bit Size:** 1/4"

**Finishing:** These puzzle parts could end up in a little ones mouth so it is a good idea to use some sort of food grade finish that would not be toxic to people.



*\*\*Always read the entire project details before starting to cut the file yourself\*\**

*\*\*Account for the thickness of the physical material on hand and the material thickness in the file\*\**

*\*\*This file is zeroed to the tables surface, Zero your bit to the tables surface\*\**



As the file starts cutting the profile of the parts make sure the cut is going all the way through the work piece and into the table surface. If you need to adjust any part of the file make sure you do not remove the hold down or you will loose position.

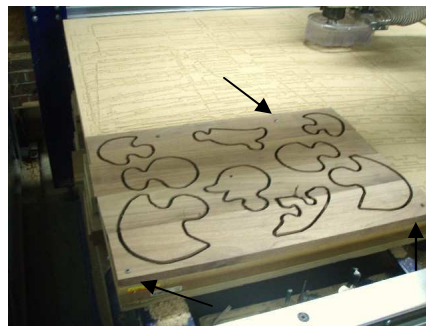

Included with the cut file is a hold down toolpath that shows where it is safe to put screws. Run this file separately from the cut file so you can screw down the work piece, or if you have a different size board or different type of hold down disregard the file.



Tabs are use to hold all the pieces to the scrap wood attached to them. Use a utility knife to score these edges. Never try to push a piece out without cutting the tab, it will tear the grain on your project. Sand remaining tab flat.

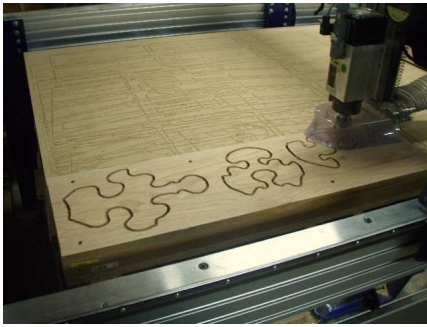

The same goes for the red oak piece, there is a toolpath file for hold down and tabs will need to be removed.



Routing the edges with a 1/4" roundover really adds to this project. The pieces are very small so make sure the proper size router and guards are in place.

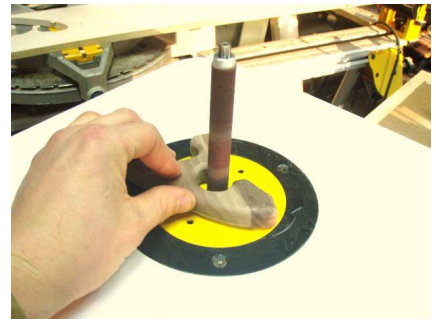

Due to the superior accuracy of the ShopBot some of the parts will be hard to fit together at first. Use a spindle sander to open up some of the pieces to fit together nicely.

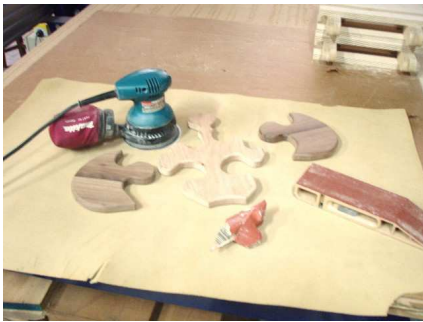

Sand the puzzle pieces thoroughly. These will be handled by many people over time and they should be very smooth.



Apply a mineral oil that is food grade in case some of these pieces end up being chewed on by little ones.



The puzzles look great and are loved by all who use them. However they are harder then they look because when parts are flipped over they do not fit with other parts that are not flipped over.

